

E7I..

FLANGIA IN ALLUMINIO

ALUMINIUM FLANGE

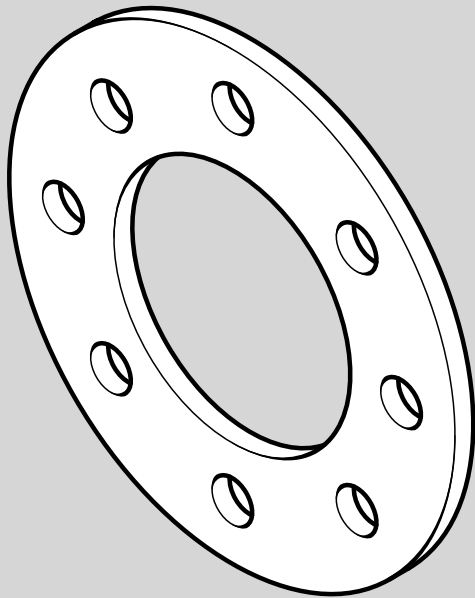

Codice/Code	PN	ø	lmb/Pack	Peso/Weight kg	Volume mc
12E7159	10-16	25	1	0,220	0,00013
12E7160	10-16	32	1	0,250	0,00015
12E7161	10-16	40	1	0,500	0,00031
12E7162	10-16	50	1	0,550	0,00036
12E7163	10-16	63	1	0,690	0,00054
12E7164	10-16	75	1	0,880	0,00068
12E7165	10-16	90	1	0,980	0,00088
12E7166	10-16	110	1	1,130	0,00106
12E7167	10-16	125	1	1,030	0,00106
12E7168	10-16	140	1	1,350	0,00137
12E7169	10-16	160	1	1,820	0,00194
12E7170	10-16	180	1	1,640	0,00194
12E7171	10	200-225	1	2,300	0,00300
12E7171/16	16	200-225	1	2,410	0,00070
12E7172	10	250	1	3,030	0,00436
12E7172/16	16	250	1	3,620	0,00426
12E7173	10	280	1	2,840	0,00436
12E7173/16	16	280	1	3,420	0,00459
12E7174	10	315	1	3,500	0,00554
12E7174/16	16	315	1	5,000	0,00677
12E7175	10	355	1	5,020	0,00561
12E7175/16	16	355	1		
12E7176	10	400	1	6,500	0,00798
12E7176/16	16	400	1		

DN	øPE	Di	R	A		Df		n° fori		Filetto viti		De		Sp	
				PN10	PN16	PN10	PN16	PN10	PN16	PN10	PN16	PN10	PN16	PN10	PN16
20	25	38	4	75	75	14	14	4	4	M12	M12	105	105	12	12
25	32	45	4	85	85	14	14	4	4	M12	M12	115	115	12	12
32	40	55	4	100	100	18	18	4	4	M16	M16	140	140	16	16
40	50	66	4	110	110	18	18	4	4	M16	M16	150	150	16	16
50	63	78	4	125	125	18	18	4	4	M16	M16	165	165	16	16
65	75	92	4	145	145	18	18	4	4	M16	M16	185	185	20	20
80	90	108	5	160	160	18	18	8	8	M16	M16	200	200	22	22
100	110	128	5	180	180	18	18	8	8	M16	M16	220	220	22	22
100	125	135	5	180	180	18	18	8	8	M16	M16	220	220	22	22
125	140	158	5	210	210	18	18	8	8	M16	M16	250	250	22	22
150	160	178	5	240	240	22	22	8	8	M20	M20	285	285	24	24
150	180	188	5	240	240	22	22	8	8	M20	M20	285	285	24	24
200	200	235	5	295	295	22	22	8	12	M20	M20	340	340	26	26
200	225	238	5	295	295	22	22	8	12	M20	M20	340	340	26	26
250	250	288	5	350	355	22	25	12	12	M20	M22	395	405	28	28
250	280	294	5	350	355	22	25	12	12	M20	M22	395	405	28	28
300	315	338	5	400	410	22	25	12	12	M20	M22	445	460	28	28
350	355	376	5	460	470	22	25	16	16	M20	M22	505	520	22	22
400	400	430	6	515	525	25	30	16	16	M22	M27	565	580	25	25

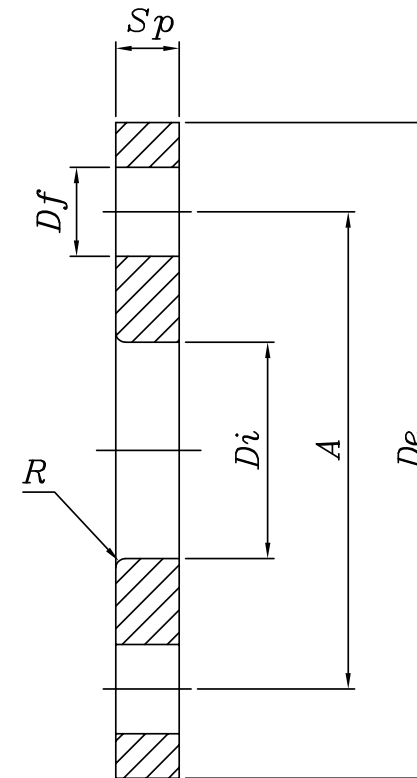

*E71 - FLANGIA in ALLUMINIO
ALUMINIUM FLANGE*

PN10-16



REV.	DATE	DESCRIPTION OF MODIFICATION
0	05.12.00	rilascio-release
FILE:\MD moduli Tabelle\ELOFIT\FLANGE\Alluminio\E71\MD309A_00.dwg		

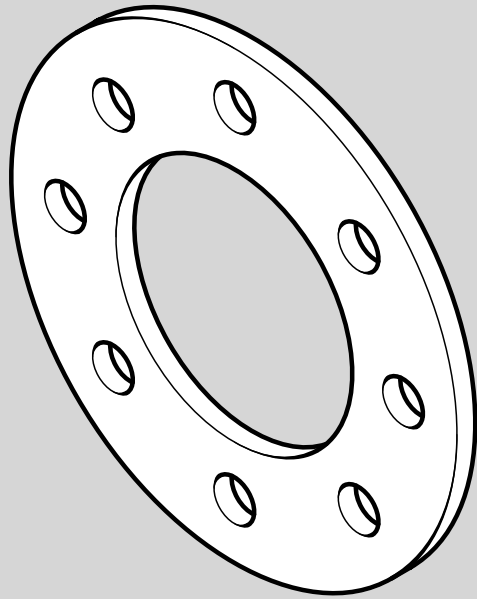

E7I..A

FLANGIA IN ACCIAIO ZINCATO
GALVANIZED STEEL FLANGE

Codice/Code	PN	∅ Polietilene	lmb/Pack	Peso/Weight kg	Volume mc
12E7159A	10-16	25	1	0,830	0,0001
12E7160A	10-16	32	1	1,030	0,0001
12E7161A	10-16	40	1	1,660	0,0002
12E7162A	10-16	50	1	1,900	0,0002
12E7163A	10-16	63	1	2,500	0,0003
12E7164A	10-16	75	1	3,000	0,0004
12E7165A	10-16	90	1	3,600	0,0006
12E7166A	10-16	110	1	4,600	0,0007
12E7167A	10-16	125	1	4,600	0,0007
12E7168A	10-16	140	1	6,200	0,0010
12E7169A	10-16	160	1	7,600	0,0014
12E7170A	10-16	180	1	7,600	0,0014
12E7171A	10	200-225	1	9,700	0,0023
12E7171/16A	16	200-225	1	9,700	0,0023
12E7172A	10	250	1	16,600	0,0032
12E7172/16A	16	250	1	16,600	0,0034
12E7173A	10	280	1	16,600	0,0032
12E7173/16	16	280	1	16,600	0,0034
12E7174A	10	315	1	19,300	0,0055
12E7174/16A	16	315	1	19,300	0,0059
12E7175A	10	355	1	29,400	0,0076
12E7175/16A	16	355	1	29,400	0,0097
12E7176A	10	400	1	36,500	0,0102
12E7176/16A	16	400	1	36,500	0,0127
12E7177A	10	450	1	40,300	0,0152
12E7177/16A	16	450	1	40,300	0,0214
12E7178A	10	500	1	40,300	0,0152
12E7178/16A	16	500	1	40,300	0,0214

Codice/Code	PN	ø	lmb/Pack	Peso/Weight kg	Volume mc
12E7179A	10	560	1	53,000	0,0219
12E7179/16A	16	560	1	53,000	0,0310
12E7180A	10	630	1	53,000	0,0219
12E7180/16A	16	630	1	53,000	0,0310





GECO SYSTEM S.p.a.©Tutti i diritti sono riservati - Riproduzione Vietata - All rights Reserved - Drawings cannot be reproduced in anyway

DN	øPE	Di	A		Df		n° fori		Filetto viti		De		Sp	
			PN10	PN16	PN10	PN16	PN10	PN16	PN10	PN16	PN10	PN16	PN10	PN16
20	25	34	75	75	14	14	4	4	M12	M12	105	105	14	14
25	32	43	85	85	14	14	4	4	M12	M12	115	115	14	14
32	40	50	100	100	18	18	4	4	M16	M16	140	140	11	12
40	50	62	110	110	18	18	4	4	M16	M16	150	150	11	12
50	63	78	125	125	18	18	4	4	M16	M16	165	165	12	13
65	75	95	145	145	18	18	4	4	M16	M16	185	185	13	14
80	90	108	160	160	18	18	8	8	M16	M16	200	200	14	15
100	110	130	180	180	18	18	8	8	M16	M16	220	220	14	16
100	125	135	180	180	18	18	8	8	M16	M16	220	220	14	16
125	140	160	210	210	18	18	8	8	M16	M16	250	250	14	17
150	160	180	240	240	22	22	8	8	M20	M20	285	285	14	18
150	180	185	240	240	22	22	8	8	M20	M20	285	285	14	18
200	200	238	295	295	22	22	8	12	M20	M20	340	340	20	20
200	225	238	295	295	22	22	8	12	M20	M20	340	340	20	20
250	250	288	350	355	22	25	12	12	M20	M22	395	405	21	21
250	280	294	350	355	22	25	12	12	M20	M22	395	405	21	21
300	315	338	400	410	22	25	12	12	M20	M22	445	460	28	32
350	355	376	460	470	22	25	16	16	M20	M22	505	520	30	36
400	400	430	515	525	25	30	16	16	M22	M27	565	580	32	38
500	450	517	620	650	25	33	20	20	M22	M30	670	715	34	42
500	500	533	620	650	25	33	20	20	M22	M30	670	715	34	42
600	560	618	725	770	30	36	20	20	M27	M33	780	840	36	44
600	630	645	725	770	30	36	20	20	M27	M33	780	840	36	44

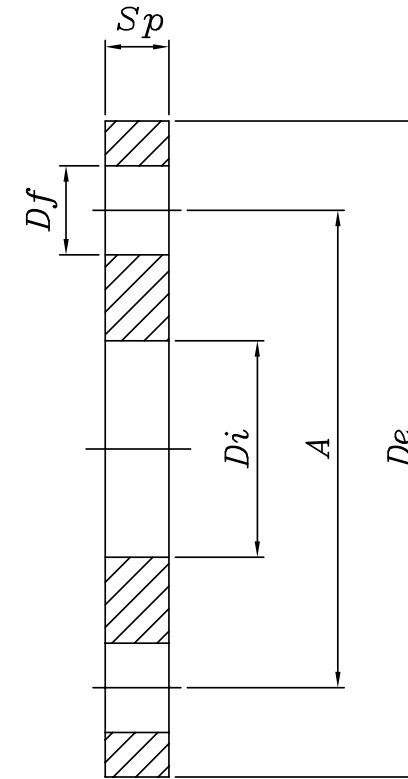

**E71A - FLANGIA in ACCIAIO ZINCATO
GALVANIZED STEEL FLANGE**

PN10-16



REV.	DATE	DESCRIPTION OF MODIFICATION
1	07.05.04	aggiunto DN500-600 PN16-included DN500-600 PN16
0	05.12.00	rilascio-release

FILE:\MD moduli Tabelle\ELOFIT\FLANGE\Acciaio\E71A\MD397A_01.dwg

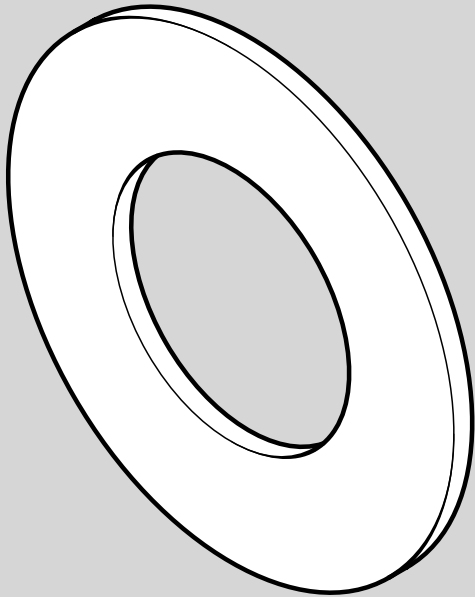

I2E7I..PP

FLANGIA IN ACCIAIO RICOPERTA IN POLIPROPILENE
POLYPROPYLENE COVERED STEEL FLANGE

Codice/Code	PN	ø	lmb/Pack	Peso/Weight kg	Volume mc
I2E7I59PP	10-16	25	1	0,313	0,000140
I2E7I60PP	10-16	32	1	0,421	0,000212
I2E7I61PP	10-16	40	1	0,624	0,000314
I2E7I62PP	10-16	50	1	0,677	0,000405
I2E7I63PP	10-16	63	1	0,780	0,000490
I2E7I64PP	10-16	75	1	1,160	0,000629
I2E7I65PP	10-16	90	1	1,400	0,000816
I2E7I66PP	10-16	110	1	1,620	0,000987
I2E7I67PP	10-16	125	1	1,440	0,000987
I2E7I68PP	10-16	140	1	2,060	0,001500
I2E7I69PP	10-16	160	1	2,620	0,001963
I2E7I70PP	10-16	180	1	2,420	0,001963
I2E7I71PP	10	200-225	1	3,180	0,002770
I2E7I72PP	10	250	1	5,840	0,005000
I2E7I73PP	10	280	1	6,280	0,005000
I2E7I74PP	10	315	1	9,860	0,072800
I2E7I75PP	10	355	1	14,700	0,111400
I2E7I76PP	10	400	1	18,140	0,015200

DN	øPE	Di	A		Df		n° fori		Filetto viti		De		Sp	
			PN10	PN16	PN10	PN16	PN10	PN16	PN10	PN16	PN10	PN16	PN10	PN16
20	25	34	75	75	14	14	4	4	M12	M12	105	105	14	14
25	32	42	85	85	14	14	4	4	M12	M12	115	115	14	14
32	40	51	100	100	18	18	4	4	M16	M16	140	140	16	16
40	50	62	110	110	18	18	4	4	M16	M16	150	150	18	18
50	63	78	125	125	18	18	4	4	M16	M16	165	165	18	18
65	75	92	145	145	18	18	4	4	M16	M16	185	185	18	18
80	90	108	160	160	18	18	8	8	M16	M16	200	200	18	18
100	110	128	180	180	18	18	8	8	M16	M16	220	220	18	18
100	125	135	180	180	18	18	8	8	M16	M16	220	220	18	18
125	140	158	210	210	18	18	8	8	M16	M16	250	250	24	24
150	160	178	240	240	22	22	8	8	M20	M20	285	285	24	24
150	180	188	240	240	22	22	8	8	M20	M20	285	285	24	24
200	200	235	295	/	22	/	8	/	M20	/	340	/	24	/
200	225	238	295	/	22	/	8	/	M20	/	340	/	24	/
250	250	288	350	/	22	/	12	/	M20	/	406	/	31	/
250	280	294	350	/	22	/	12	/	M20	/	406	/	34	/
300	315	338	400	/	22	/	12	/	M20	/	460	/	34	/
350	355	376	460	/	22	/	16	/	M20	/	520	/	39	/
400	400	430	515	/	26	/	16	/	M22	/	580	/	43	/

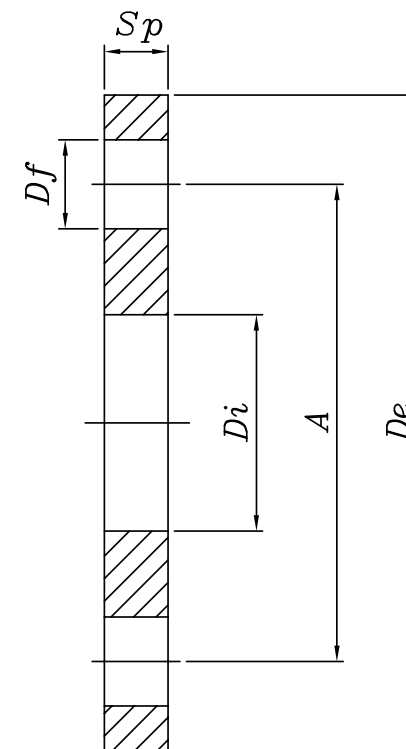

**E71PP – FLANGIA in ACCIAIO RICOPERTA
in POLIPROPILENE
POLYPROPYLEN COVERED STEEL
FLANGE**

PN10-16



REV.	DATE	DESCRIPTION OF MODIFICATION
0	28.11.03	rilascio-release
FILE\MD moduli Tabelle\ELOFIT\FLANGE\Acciaio-Polipropilene\E71PP\MD398A_00.dwg		

Le informazioni contenute in questo documento possono essere soggette a cambiamenti senza preavviso - Information on this document are subject to change without notice



EGR

GUARNIZIONE IN NEOPRENE

NEOPRENE GASKET

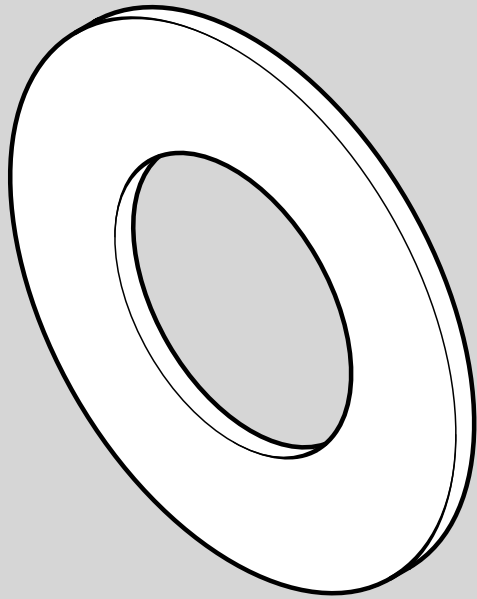

Codice/Code	∅	Imb/Pack	Peso/Weight kg	Volume mc
I2EGR025	25			
I2EGR032	32			
I2EGR040	40			
I2EGR050	50			
I2EGR063	63			
I2EGR075	75			
I2EGR090	90			
I2EGR110	110			
I2EGR125	125			
I2EGR140	140			
I2EGR160	160			
I2EGR180	180			
I2EGR200	200			
I2EGR225	225			
I2EGR250	250			
I2EGR280	280			
I2EGR315	315			
I2EGR355	355			
I2EGR400	400			
I2EGR450	450			
I2EGR500	500			
I2EGR560	560			
I2EGR630	630			

$\varnothing PE$	Di	De	Sp
25	22	58	3
32	25	68	3
40	31	78	3
50	39	88	3
63	50	102	3
75	63	122	3
90	71	138	3
110	92	158	3
125	104	169	3
140	114	188	4
160	134	212	4
180	154	211	4
200	166	268	4
225	188	268	4
250	267	328	3
280	267	328	3
315	318	378	3
355	368	438	3
400	420	490	3
450	520	595	3
500	520	595	3

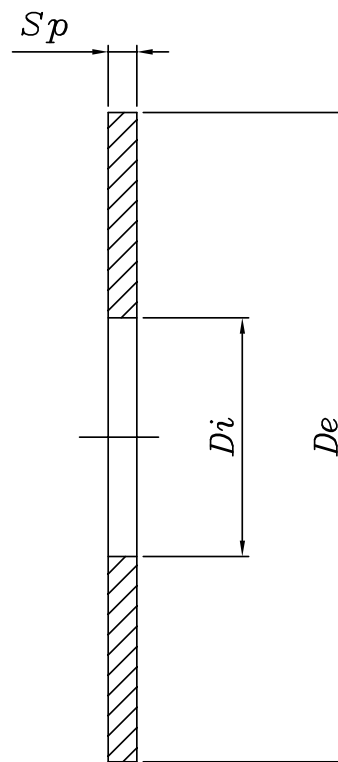

*EGR – GUARNIZIONE in NEOPRENE
NEOPRENE GASKET*

REV.	DATE	DESCRIPTION OF MODIFICATION
1	05.05.04	aggiunto EGR450-500-included EGR450-500
0	15.06.99	rilascio-release

FILE:\MD moduli Tabelle\ELOFIT\GUARNIZIONE\Neoprene\EGR\MD310A_01.dwg

